



SHAWNEE COUNTY

REQUEST FOR QUOTES (RFQ)

Quotation Number: 012-23 Vendor Name: _____
Date Issued: 02-16-2023 Address: _____
Closing Date: 03-15-2023, 2:00pm Phone Number: _____

THIS IS NOT AN ORDER

1. In communications, always refer to the above quotation number.
2. All prices and conditions must be shown. Additions or conditions not shown on this bid will not be allowed.
3. Shawnee County reserve the right to accept or reject any part of, or all of, any bid or proposal.
4. All prices quoted are to be less Federal Excise Tax and Kansas Sales Tax.
5. Price quoted shall remain firm for ninety (90) days after bid closing date.

SHAWNEE COUNTY HAS AN ELECTRONIC BID SYSTEM

All vendors are required to create an online portal account (www.snco.us/purchasing) in order to receive or submit bid requests.

ITEM AND DESCRIPTION

Shawnee County is soliciting sealed bids
Project No. S-221002.00: Shawnee County Annex – South Parking Lot Pavement & Sidewalk Repairs
1515 NW Saline Street, Topeka, Kansas
per the following minimum specifications

- Provide all labor, materials, and equipment necessary to remove and replace concrete pavement and sidewalk in the south parking lot.

BID SPECIFICATION

All construction methods and material used in the construction of the improvements shall be in accordance with the Shawnee County GENERAL CONDITIONS (www.snco.us/publicworks), City of Topeka – Shawnee County Standard Technical Specifications (STD) (topeka.org/engineering/design-right-of-way), latest edition including all addenda thereto.

SC-1: The Work will commence with an issuance of a Start Work Order by the Owner.

EARLIEST START DATE: Monday April 17, 2023

LATEST START DATE: Monday September 4, 2023

Contractor has (60) Calendar Days from the date Start Work Order is issued by the Owner to have the project certified as being Complete and Ready for Final Payment and Acceptance.

For project to be certified Complete, all work must be complete and parking lot reopened.

For the project to be certified Ready of Final Acceptance and Payment, the contractor shall have submitted a signed copy of both the Final Pay Application and Change Order reconciling “As Bid” verses “As Constructed” final quantities to the Owner.

In the event the contract work is not certified as being Complete and ready for Final Acceptance and Payment by the dated specified on the Construction Work Order, Liquidated Damages shall be assessed at the rate of Seven Hundred Fifty Dollars & no/100's (\$750.00) per calendar day until the project is certified by Shawnee County as being Complete and Ready for Final Acceptance and Payment.

A Pre-Construction Conference shall be held 15 Calendar Days in advance of the Contractors proposed Start Works Date to discuss project and answer any questions presented.

Time: 1:30 PM

**Place: Shawnee County Annex, 1515 Saline Street
Public Works Conference Room, 2nd Floor**

PLEASE SUBMIT ATTACHMENT 1 AS THE FIRST PAGE OF YOUR BID

BID RESPONSE

Closing Date: Bids will be received until 2:00 p.m. CDT on the scheduled closing date. The online bid portal will not accept any new bids after this time.

Signature of Bids: Each bid must show in the space provided the complete business or mailing address of the bidder and must be signed by him/her with his/her usual signature.

Withdrawal of Bids: Bids already submitted may be withdrawn on the Electronic Bid System or upon proper identification of bidder and provided request is received prior to time of closing. Negligence on the part of the bidder in preparing the bid confers no right for the withdrawal after the time set for closing of bids.

Register Your Company: For a *mandatory* pre bid meeting, you *must* be registered in our bid portal for us to record you as an attendee. If you are not marked as attended, the system will not allow you to download a bid. It will also stop you from downloading your bid if you are not registered. Also, you will need to subscribe to the bid types you can provide. This will automatically send you bid requests in the future.

Please Submit Your Bids Early: In case you have problems getting your bid to download and need assistance, we suggest you do not wait until the last minute. Our system will not allow any bids to be

downloaded after 2:00 pm. If your pricing changes, you can replace your bid in the system any time before the 2:00 closing.

Bid Openings: All bids submitted before the specified bid closing time shall be opened and properly recorded on the bid tabulation sheet. Subsequent to the bid opening, all bids shall be thoroughly evaluated and a determination made as to their compliance with applicable specifications. The appropriate County department head shall make this determination. Upon completion of the above determination, an analysis of all bids submitted shall be prepared and formally presented to the Board of County Commissioners for acceptance and approval of the lowest and/or best bid. The Board of County Commissioners reserves the right to accept or reject any and/or all bids and to waive any irregularities or informalities therein.

Notice to Successful Bidders: The successful bidder will be notified by email or telephone as soon as possible after bids have been opened, tabulated, and analyzed.

Notice to Unsuccessful Bidders: Unsuccessful bidders will not be notified.

TERMS AND CONDITIONS

In the event that goods or services delivered by the vendor are unsatisfactory and remain unsatisfactory after a notice and an opportunity to correct the deficiencies, the County reserves the right to purchase substitute goods or services from the other bidders.

Shawnee County reserves the right to negotiate separately with any vendor after the opening of this RFQ when such action is considered in its best interest. Subsequent negotiations may be conducted, but such negotiations will not constitute acceptance, rejection or a counteroffer on the part of the County.

Shawnee County interprets the term “lowest responsible and best bidder” as requiring Shawnee County to:

- A. Choose between the kinds of materials, goods, wares, or services subject to the proposal, and
- B. Determine which proposal is most suitable for its intended use or purpose. Shawnee County can consider among other factors such things as labor cost, service and parts availability and maintenance costs of items upon which proposals are received. Shawnee County can determine any differences or variations in the quality or character of the material, goods, wares or services performed or provided by the respective vendors.

Shawnee County will award the bid. If the successful vendor refuses or fails to make deliveries of the materials/services within the times specified in the RFQ, purchase order or contractual agreement, Shawnee County may by written notice, terminate the contract OR purchase order. The successful vendor will certify and warrant that goods, personal property, chattels, and equipment sold and delivered are free and clear of any and all liens, or claims of liens, for materials or services arising under, and by virtue of the provisions of K.S.A. 58-201, et seq., and any other lien, right, or claim of any nature or kind whatsoever.

The vendor hereby certifies that he or she has carefully examined all of the documents for the project, has carefully and thoroughly reviewed this RFQ, understands the nature and scope of the work to be done; and that this proposal is based upon the terms, specifications, requirements and conditions of the RFQ, and documents. The vendor further agrees that the performance time specified is a reasonable time, having carefully considered the nature and scope for the project as aforesaid.

Shawnee County will use discretion with regards to disclosure of proprietary information contained in any response, but cannot guarantee the information will not be made public. As a governmental entity, Shawnee

County is subject to making records available for disclosure pursuant to the Kansas Open Records Act. Any confidential or proprietary information should be clearly marked.

Shawnee County reserves the right to enter into agreements subject to the provisions of the Cash Basis Law (K.S.A. 10-1112 and 10-1113), the Budget Law (K.S.A.79-2935). Agreements shall be construed and interpreted so as to ensure that the County shall at all times stay in conformity with such laws, and as a condition of agreements the County reserves the right to unilaterally sever, modify, or terminate agreement at any time if, in the opinion of its legal counsel, the Agreement may be deemed to violate the terms of such law.

The vendor certifies that this proposal is submitted without collusion fraud, or misrepresentation as to other vendors, so that all proposals for the project will result from free, open, and competitive proposing among all vendors.

This RFQ, responses thereto and any contract documents will be governed by the law of the State of Kansas. Any dispute arising out of the same will be litigated only within the courts of the State of Kansas.

Vendor agrees that all data, documents, and information, regardless of form that is generated as a result of this RFQ are the property of Shawnee County. The County shall not be liable to reimburse any vendor for the costs of creating, compiling or delivering the same to the County.

By submission of a response, the proposer agrees that at the time of submittal, it: 1) has no interest (including financial benefit, commission, finder's fee, or any other remuneration) and will not acquire any interest, either direct or indirect, that would conflict in any manner or degree with the performance of proposer's services, or 2) benefit from an award resulting in a "Conflict of Interest." A "Conflict of Interest" will include holding or retaining membership, or employment, on a board, elected office, department, division, or bureau, or committee sanctioned by and/or governed by the Board of Shawnee County Commissioners of the County of Shawnee, Kansas. Proposers will identify any interests, and the individuals involved, on separate paper with the response and will understand that the County may reject their proposal at its sole discretion.

No gifts or gratuities of any kind shall be offered to any County employee at any time.

The Proposer certifies that this proposal is submitted without collusion, fraud, or misrepresentation as to other Proposers, so that all proposals for the project will result from free, open, and competitive proposing.

The County is exempt from the payment of Federal and excise taxes and from Kansas sales tax.

Vendor credit agreements are prohibited. Unless otherwise stated in this document, payment will be made from vendor-submitted invoice(s) via ACH transfer, check, or credit card, net 30 days. Shawnee County will not complete any credit application or agree to credit terms supplied by vendor.

Nondiscrimination: Shawnee County is committed to the concept of equal employment opportunity. All bidders and contractors are expected to comply with the provisions of K.S.A. 44-1030 and 44-1031, copies of which are attached and shall be a part of this contract and other applicable Federal and Kansas laws governing equal employment opportunity.

In accordance with K.S.A 44-1030, vendor hereby agrees to the following:

- A. He or she will observe the provision of the Kansas Commission on Human Rights and will not discriminate against any person in the performance of work under the present contract because of race, religion, color, sex, national origin, ancestry, or physical disability.
- B. In all solicitations or advertisements for employees, he or she will include the phrase, "Equal Opportunity Employer", or a similar phrase to be approved by the Kansas Commission on Human Rights.
- C. If he or she fails to comply with the manner in which he or she will be deemed to have breached the present contract, and it may be canceled, terminated, or suspended, in whole or in part, by Shawnee County, Kansas.
- D. If he or she is found guilty of a violation of the Kansas Act Against Human Rights under a decision, or order of the Kansas Commission on Human Rights which has become final, he or she will be deemed to have breached the present contract, and it may be canceled, terminated, or suspended, in whole or in part, by Shawnee County, Kansas; and,
- E. He or she will include the provisions of subsections (a) through (d) inclusively of this paragraph in every subcontract or purchase order so that such provision will be binding upon such subcontractor or vendor.

Provisions of K.S.A. 44-1030 Statute:

Mandatory provisions applicable to contracts of the state and other political subdivisions; cancellation, when; application to subcontract; non-application to certain contract. (a) Except as provided by subsection (c) of this session, every contract for or on behalf of the state or any county or municipality or other political subdivision of the state or any agency of or authority created by any of the foregoing, for the construction, alteration or repair of any public building or public work or for the acquisition of materials, equipment, supplies or services shall contain provisions by which the contractor agrees that:

- 1. The contractor shall observe the provisions of the Kansas act against discrimination and shall not discriminate against any person in the performance of work under the present contract because of race, religion, color, sex physical handicap unrelated to such person's ability to engage in the particular work, national origin or ancestry.
- 2. In all solicitations or advertisements for employees, the contractor shall include the phrase, "equal opportunity employer," or a similar phrase to be approved by the commission.
- 3. If the contractor fails to comply with the manner in which the contractor reports to the commission in accordance with the provisions of K.S.A. 44-1032, the contractor shall be deemed to have breached the present contract and it may be cancelled, terminated or suspended, whole or in part, by the contracting agency.
- 4. If the contractor is found guilty of a violation of the Kansas act against discrimination under a decision or order of the commission which has become final, the contractor shall be deemed to have breached the present contract and it may be cancelled, terminated or suspended, in whole or in part, by the contracting agency.
- 5. The contractor shall include the provisions of paragraphs one (1) through four (4) inclusively of this subsection (a) in every subcontract or purchase order so that such provisions will be binding upon such subcontractor or vendor. (b) The Kansas commission on civil rights shall not be prevented hereby from

requiring reports of contractors found to be not in compliance with the Kansas act against discrimination. (c) The provisions of this section shall not apply to a contract entered into by a contractor: (1) Who employs fewer than four (4) employees during the term of such contract; or (2) Whose contracts with the governmental entity letting such contract cumulatively total five thousand dollars (\$5,000) or less during the fiscal year of such governmental entity.

Provisions of K.S.A. 44-1031 Statute:

Same; personnel to be used in performing contracts; reports; non-application to certain contractors. Every person, as defined in subsection (a) of K.S.A. 44-1002, who wishes to enter into a contract which is covered by the provisions of K.S.A. 44-1030 shall upon request of the commission, inform the commission in writing of the manner in which such person shall recruit and screen personnel to be used in performing the contract. The report shall be made on forms to be supplied by the commission. The provisions of K.S.A. 44-1030 and of this section shall not apply to any contractor who has already complied with the provisions of such sections by reason of holding a contract with the federal government or a contract involving federal funds.

History: L.1972, ch.184, & 15; L. 1975, ch. 264, & 8; L. 1977, ch. 183, & 2; July 1.

All questions regarding this bid should be posted on the online Electronic Bid System.

For problems with the online Electronic Bid System, please contact:

Shawnee County Audit Finance Department

e-mail: Auditfinance@snco.us phone: (785) 251 – 4039

The undersigned agrees with all terms and conditions stated above:

Signature	_____
Printed Name	_____
Title	_____
Email Address	_____
Phone Number	_____

ATTACHMENT 1**012-23 – North Annex Parking Lot****BID FORM**

Item	Description	Quantity	Unit	Unit Price	Extension
1	Mobilization	1	LS		
2	Pavement Removal	783	SY		
3	6" Concrete Pavement Class-A Reinforced with 6x6-W2.9xw2.9 Wire Mesh @ 42#/100 sf	783	SY		
4	6" Concrete Standup Curb	10	LF		
5	Remove & Replace 4" Concrete Sidewalk with Turndown Edge	384	SF		
Total					

Note: Quantities are estimated. Measurement and Payment will be the Unit Price as measured in the Field.

Company or Firm Name

By: _____

PLEASE SUBMIT ATTACHMENT 1 AS THE FIRST PAGE OF YOUR BID

1	2	3	4	5	6	7	8	9	10	11	12	13	14	15	16	17	18	19	20	21	22	23	24	25	26	27	28	29	30	31	32	33	34	35	36	37	38	39	40	41	42	43	44	45	46	47	48	49	50	51	52	53	54	55	56	57	58	59	60	61	62	63	64	65	66	67	68	69	70	71	72	73	74	75	76	77	78	79	80	81	82	83	84	85	86	87	88	89	90	91	92	93	94	95	96	97	98	99	100
---	---	---	---	---	---	---	---	---	----	----	----	----	----	----	----	----	----	----	----	----	----	----	----	----	----	----	----	----	----	----	----	----	----	----	----	----	----	----	----	----	----	----	----	----	----	----	----	----	----	----	----	----	----	----	----	----	----	----	----	----	----	----	----	----	----	----	----	----	----	----	----	----	----	----	----	----	----	----	----	----	----	----	----	----	----	----	----	----	----	----	----	----	----	----	----	----	----	----	-----

Shawnee County
Public Works Department
1515 NW Saline Street
Topeka, Kansas 66618
(785) 233-7102



Saved under: P:\AutoCAD\Drawings\Auto\concrete.dwg
Sheet 1 of 1

GENERAL NOTES

- All construction methods and materials used in the construction of the improvements covered by this plan shall be in accordance with the Shawnee County GENERAL CONDITIONS (www.scco.us/publicworks) and City of Topeka - Shawnee County Standard Technical Specifications (STD) (www.topeka.org/engineering/design-right-of-way), latest edition including all addenda thereto.
- Concrete furnished for this improvement shall be in accordance with City-of-Topeka/ Shawnee County Standard Technical Specifications SECTION 5 - Concrete Pavement and Structures:
 - Parking Lot and Curb: Pavement Class - A
 - Sidewalk with Turndown Edge: Pavement Class - B
- Perimeter of pavement area, as marked in the field, to be removed shall be saw cut full-depth. If pavement is damaged beyond the limits of the saw cut, the pavement shall be re-sawn, paralleling the original saw cut, beyond the limits of the damaged area and replaced by the Contractor at the Contractor's expense. Saw cuts shall not be paid for directly but shall be SUBSIDIARY to other bid items. Additionally, sidewalk and curb to be removed shall be saw cut full-depth as marked in the field.
- Tie perimeter of new pavement to existing pavement or curb with dowels - #4 Rebar x 24" @ 5'-0" centers. Dowels and dowel placement shall not be paid for directly but shall be SUBSIDIARY to other bid items.
- Subgrade areas beneath parking lot pavement shall be accepted by the Engineer for placement of concrete pavement after being proof-rolled with a tandem axle dump truck loaded to a minimum of 25 tons without rutting or pumping. Proof rolling shall not be paid for directly but SUBSIDIARY to other items.

Shawnee County Annex
1515 NW Saline

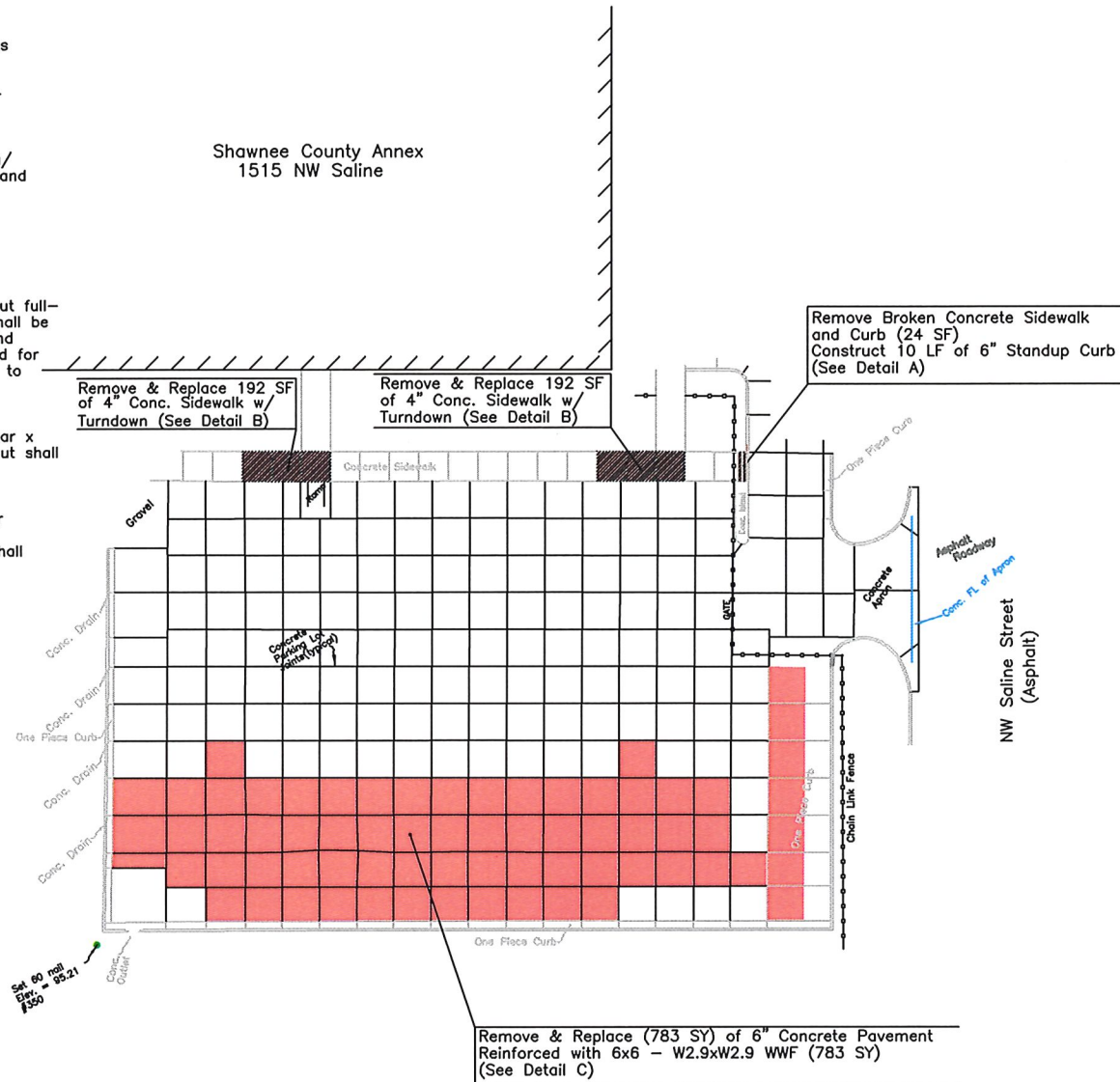

PROJECT QUANTITIES
SOUTH PARKING LOT REPAIRS
SNCO ANNEX, 1515 SALINE ST.
S-221002.00

PROJECT QUANTITIES			
ITEM	DESCRIPTION	QTY	UNITS
1	Mobilization	1	LS
2	Pavement Removal	783	SY
3	6" Concrete Pavement CLASS-A Reinforced with 6x6 - W2.9xW2.9 Wire Mesh® 42#/100SF	783	SY
4	6" Standup Curb	10	LF
5	Remove and Replace 4" Concrete Sidewalk w/Turndown Edge	384	SF

Note: Tie perimeter of new pavement or curb with #4 bars x 24" dowels at 5'-0" centers. Dowels will not be paid for directly but shall be subsidiary to other bid items.

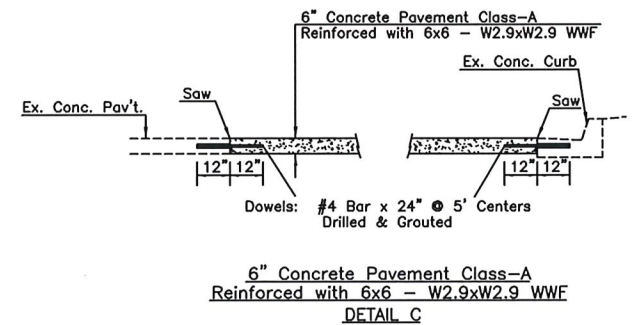
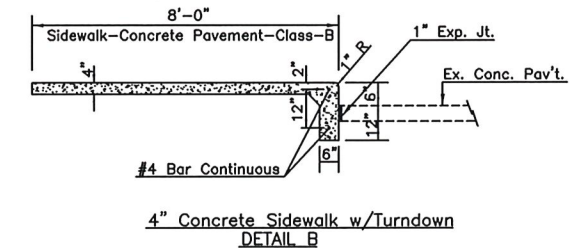
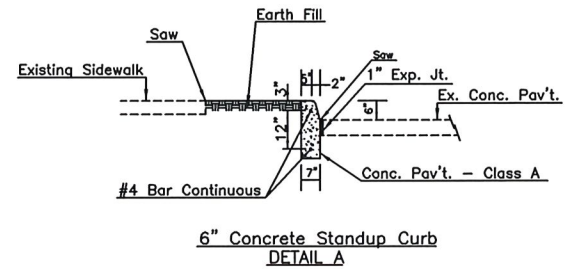

- 6" Concrete Pavement Class-A Reinforced with 6x6 - W2.9xW2.9 WWF
- Remove and Replace 4" Concrete Sidewalk With Turndown



Not to Scale

Benchmarks
Top of Water Meter East of Drive = 100.74
Top of Fire Hydrant East of Drive = 102.93
X cut set in curb 65' South and 80' East of NE cor. bldg. = 99.48

Datum and bearings are assumed.

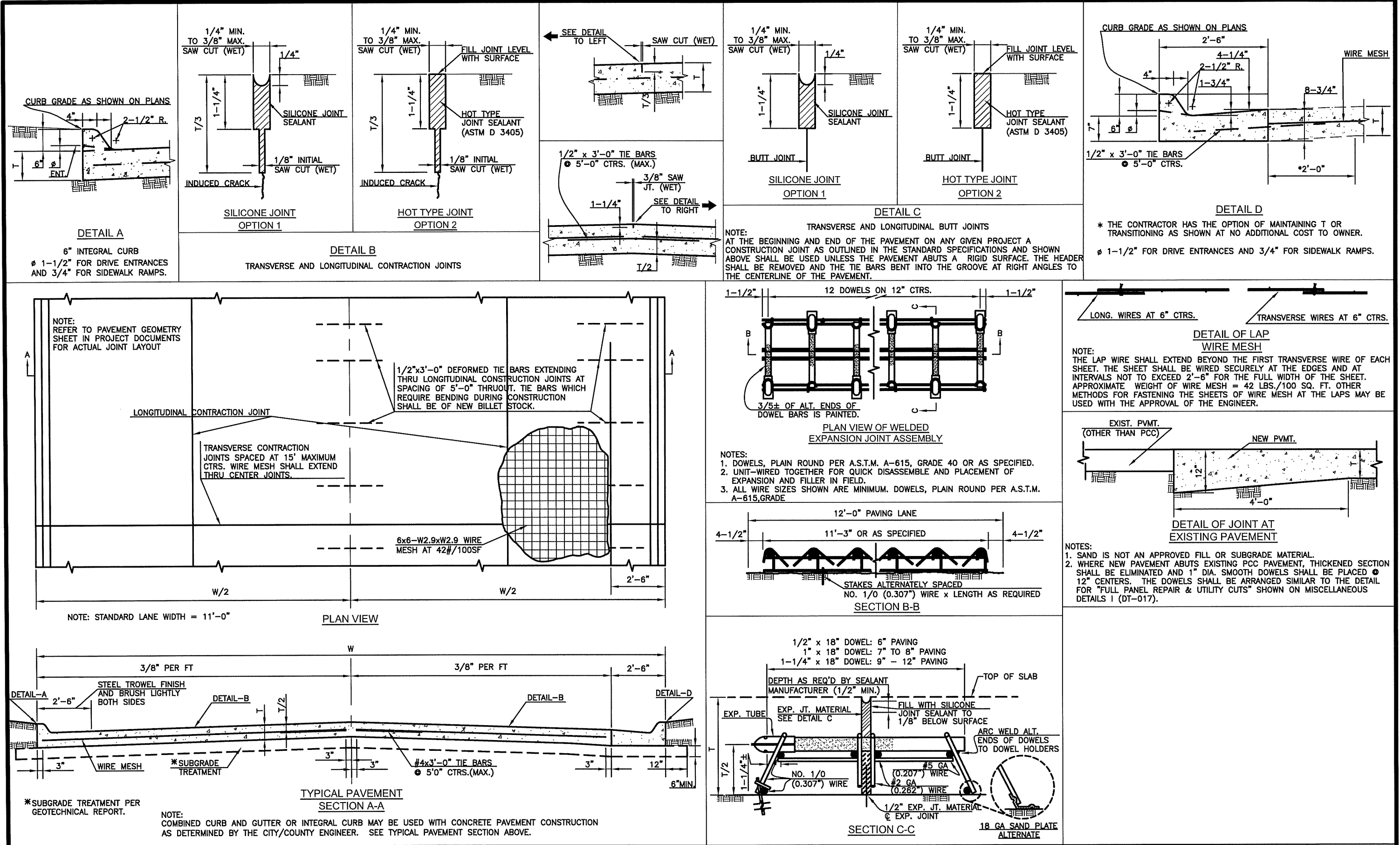

6	June 2018	Eliminated sealing butt joint at curb toe	DHS	JVH	DRAWN BY: <i>mm/mc</i>	 SHAWNEE COUNTY, KANSAS PUBLIC WORKS DEPARTMENT 1515 NW SALINE TOPEKA, KS 66618 (785) 233-7702	 TOPEKA <i>Public Works</i> ENGINEERING 620 SE MADISON St. • 2nd Floor • TOPEKA, KS 66607 Phone: (785) 368-3842 • Fax: (785) 368-3881	STANDARD DETAILS	CONCRETE PAVEMENT DETAILS (DT-002)	DATE: _____ SHEET: _____ PROJ.: _____
5	March 2013	Made bar size " & added ref. to DT-017	DHS	SB	APP'D BY: <i>PC</i>					
4	Dec. 2012	Changed to tie bars at Detail D	DHS	SB						
3	March 2010	Eliminated keyed joint at Typical Section	DHS	SB						
2	Dec. 2009	Eliminated keyed joints	DHS	SB						
1	Feb. 2008	Mod. Det.'s B,C&D and Sect.'s A-A&D-D	DHS	SB						
NO.	DATE	REVISION	BY	APP'D						

SUBMITTAL CONTROL SHEET

Project: SNCO Annex, 1515 NW Saline St. - S. Parking Lot Pavement & Sidewalk Repairs															Project Manager:			
Project No.: S-221002.00																	Contractor:	
Section No.	Specifications Section Title	Samples	Shop Dwgs.	Matl. Or Parts List	Descriptive Data	Mfrgs Literature	Mix Designs	Certifications	Operation Instr.	Tests	Date of Submittal	Date Rejected	Date Revise & Resubmit	Date Make Corrections Noted	Date No Exceptions Taken	Notes		
	COT & SNCO Std Tech Spec - SECTION 5 - Concrete Pavement & Structures, Subsection 5.01, Paragraph A(2) - Pavement Class-A						X											
	COT & SNCO Std Tech Spec - SECTION 5 - Concrete Pavement & Structures, Subsection 5.05, Paragraph B(5) - <u>Hot Type Joint Sealants</u>							X										

Note: Contractor shall furnish all specified submittal's indicated on the Submittal Control Sheet as directed by the Engineer.